

olivetti



d-COLOR MF450 and MF550

MULTIFUNCTION COLOUR DIGITAL SYSTEMS

COLOUR



MULTIFUNCTION



SPEED



MODULAR

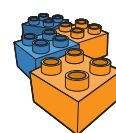

NETWORK

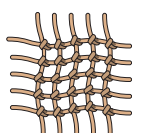

d-COLORMF450 and MF550

MULTIFUNCTION COLOUR DIGITAL SYSTEMS



A COMPLETE ARRAY OF PROFESSIONAL COLOUR SHADES

Advanced multi-function systems deliver speed and networking for large departmental organisations

MAIN CHARACTERISTICS

1024 MB MEMORY AND 60 GB HDD	LARGE 8.5" COLOUR CONTROL PANEL
DUPLEX FOR PAPER FORMATS UP TO 256 g/m ²	STANDARD PAPER CAPACITY 3650 CUT SHEETS
STANDARD POSTSCRIPT 3	ADVANCED SECURITY OPTIONS
FAST AND FLEXIBLE SCANNING AT UP TO 70 opm	PROFESSIONAL FINISHING OPTIONS

EFFICIENCY AND PRODUCTIVITY

The Olivetti d-Color MF450 and d-Color MF550 are innovative multi-function systems with a **60 GB Hard Disk** to simplify information access and transmission.

Based on **single-pass tandem technology**, they operate at **impressive speeds** of 45 ppm and 55 ppm respectively, for b/w and colour jobs with the A4 format. Their **1024 MB memory** ensures efficient management of complex documents and print queues.

COMPATIBILITY

The Olivetti d-Color MF450 and d-Color MF550 feature an **innovative print controller** for complete integration with the corporate network and support for the Windows, MAC, Unix and Citrix operating systems. Both devices have a **single user interface** encompassing PCL and PostScript,

for fast and easy execution of all print processes run by the user software.

SECURITY

The distinguishing feature of these two models is the revolutionary **biometric authentication option**, a system that enhances security and protection by identifying each user's individual physical characteristics. This eliminates the possibility of false authentications and avoids the need for users to remember ID codes. Additional security features include a **PDF encryption** function to prevent unauthorised access to PDF data, and a **secure printing function** that allows jobs sent to the system to be printed only when the user keys in a personal password.



POLYMERISED TONER for excellent colour printouts



ADVANCED SECURITY FUNCTIONS via fingerprints



Touch-screen colour **CONTROL PANEL**

COLOUR

The polymer toner ensures outstanding fidelity, brightness and definition, for **superior colour images**; chromatic stability is tested and guaranteed on cycles of up to 1,000 continuous copies.

The toner provides excellent performance and reliability to ensure superior quantitative yields, and helps **save energy** by operating at lower temperatures.

DESIGN

The d-Color MF450 and MF550 combine **style and elegance** with functionality and leading-edge technology. Based on an all-round design concept, these Olivetti multi-function devices act as hub for all of the company's printing needs.

Thanks to their **compact design** and broad **colour display**, which can be tilted and swivelled, they add a touch of class to any environment, creating a stylish focus of attention in the office.

SMALL-SCALE PUBLISHING

The Olivetti d-Color MF450 and MF550 guarantee **efficient, cost-effective** production of a wide range of documents, including business cards, posters, brochures, leaflets. Superior printing quality and a broad choice of professional finishing options allow users to handle the entire production process in-house, for printed material of the highest standard.



Corner stapling



2-point stapling



Duplex



Combined mixplex/mixmedia



Sheet insertion, report



Letter fold



Booklet



Offset sorting

HIGH-DEFINITION IMAGES AND TEXTS: THE PERFECT SOLUTION FOR IN-HOUSE PUBLISHING



A MODULAR SYSTEM THAT GROWS AS USER NEEDS CHANGE



OPTIONS

Finishing units (only for MF450)

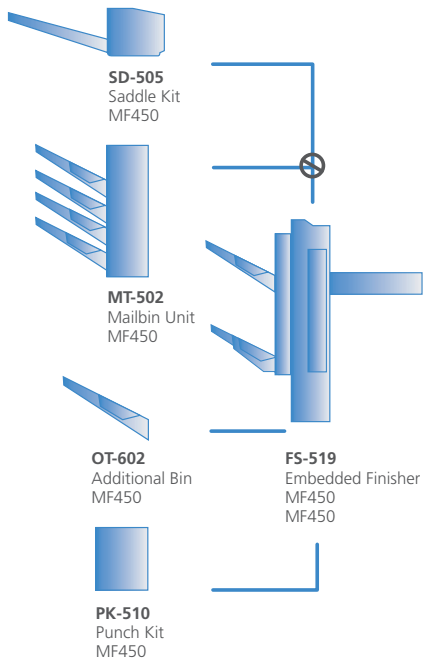

Finishing units (only for MF550)

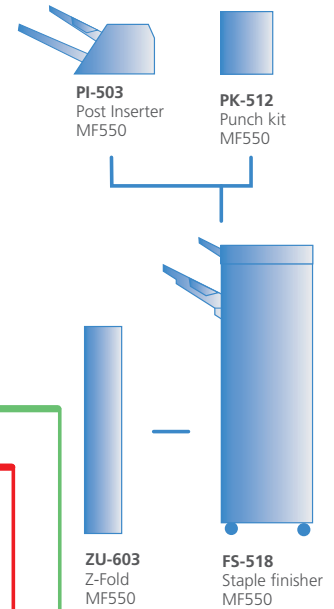

Common options

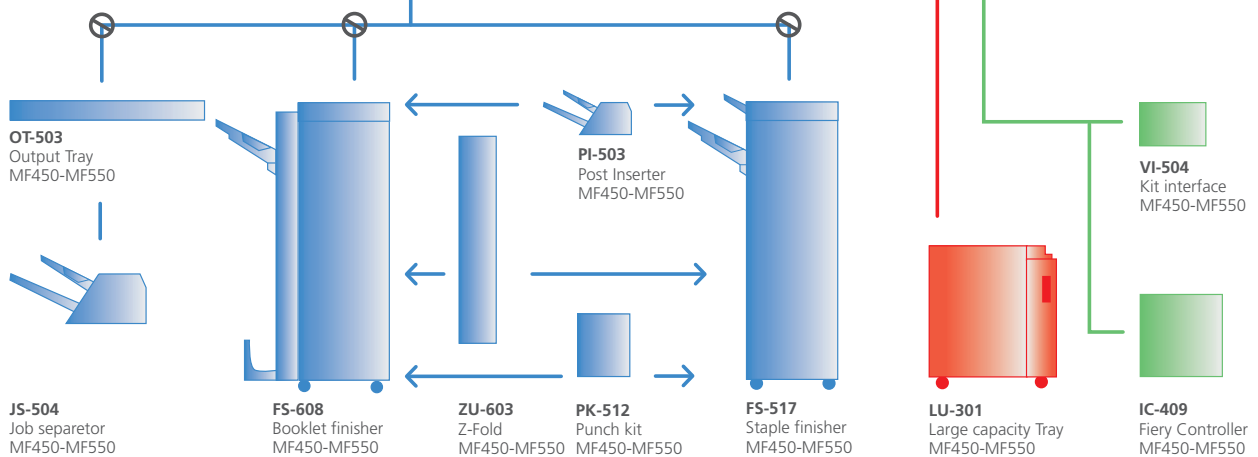

⊗ in alternative



A POWERFUL NETWORK COMMUNICATION TOOL

The scanner is a vital tool for circulating information on the company network. The integrated duplex unit simplifies scanning jobs for easier document networking. In addition to the usual functions of scan-to-email, scan-to-FTP, in the JPEG and TIFF formats, the d-Color MF450 and d-Color MF550 offer a **multi-page capability** to automatically convert heavier documents into ultra-compressed PDF files, for faster, streamlined transmission. Both devices enhance standard fax transmission procedures with a **series of**

digital functions for more flexible fax management and lower telephone costs: colour fax transmission and storage with IP fax, transmission and reception of mail attachments via Internet Fax and re-routing of fax sent to PCs. With the **Box function**, all documents managed by the system can be memorised, archived and shared, for efficient data flows. The Box function can be used to **display previews** on the control panel of documents stored on the 60 GB hard disk, minimising the possibility of mistakes and wasted paper.

NETWORK SHARING

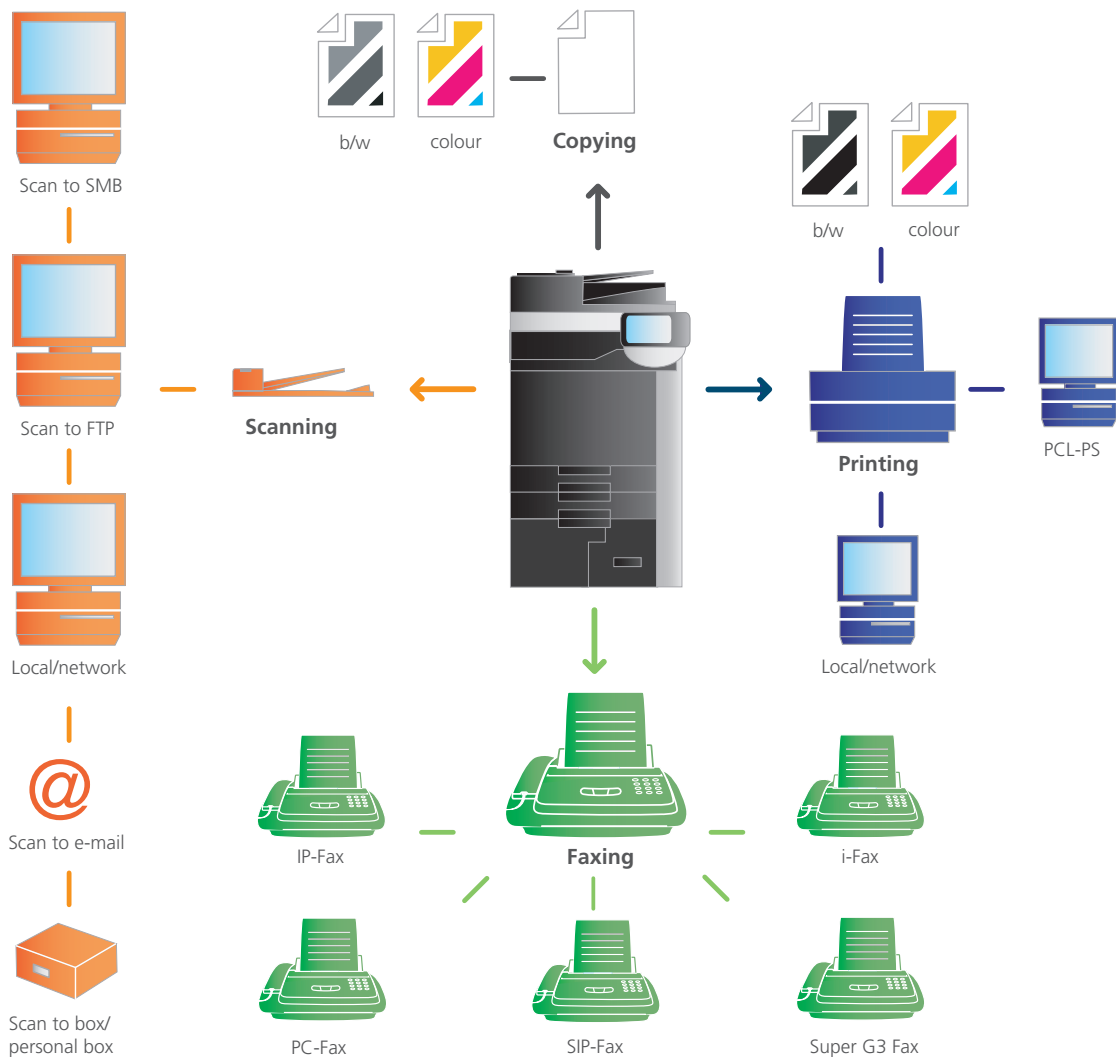



GENERAL SPECIFICATIONS

GENERAL	Type desktop/console	Full-Colour console	Paper weight	64-300 g/m ²
	Technology	Tandem type Indirect electrophotographic	Greyscale	256 levels
	CPU Controller	Power PCMC7448@867MHz	Warm-up time	Approx. 30 seconds
	System Memory	1.024MB	Power requirements	220-240V 10A 50/60Hz
	HDD	60 GB (Standard)	Power consumption	Less than 2000 W (system)
	Interfaces	10-Base-T/100-Base-T/1000-Base-T Ethernet, USB 2.0	Paper Capacity	Std: 3,650 sheets Max.: 6,650 sheets
	First Copy Time	Colour: 6,5 seconds (A4) MF450: 4,8 seconds in B/W (A4) MF550: 4,3 seconds in B/W (A4)	Automatic Duplexing	A5 - A3 Wide; 64 - 256 g/m ²
	System speed	MF450: 45 ppm B/W and 45 ppm in colour (A4) 23 ppm B/W and 23 ppm in colour (A3) MF550: 55 ppm B/W and 45 ppm in colour (A4) 28 ppm B/W and 23 ppm in colour (A3)	Dimensions (WxDxH)	650 x 777 x 1,150 mm
	Paper input capacity	Up to 100 sheets	Weight	Approx. 190 kg
	By-pass	Up to 150 sheets (up to 300 g/m ²)	Finishing (option)	Offset, collate, stapler, hole punch, centre fold, letter fold, booklet
Paper size	A6 - A3 Wide (311x457 mm), customised format	Lifetime consumables	Toner: up to 45,000 pages BLACK, up to 27,000 pages CMY Imaging unit: up to 300,000 pages BLACK, up to 100,000 pages CMY	
COPIER	Resolution	600 x 600 dpi	Copy features	Chapter and cover mode, proof copy, adjustment test print, glossy mode, colour adjustment digital art, job recall, job setting memory, poster mode, overlay, stamping
	Warm-up Time	Approximately 85 seconds		
	Multiple Copy	1-999 sheets		
	Zoom	25-400% (0,1 % step)		
PRINTER	Risoluzione di stampa	1,800 x 600 dpi	Operating Systems	Windows 2000/XP/XP64/Vista 32/64 (under development); Machintosh 9.x/10.x, Server 2000/2003/2003 x64, Unix, Linux, Citrix
	Languages	PCL 6c (PCL 5c + XL3.0), PostScript 3		
	Print functions	PCL, PS, TIFF, and PDF direct print, mixmedia and mixplex, protection copy		
SCANNER	Type	Colour scanner	Scan modes	Scan to FTP, Scan to SMB, Scan to e-mail, Scan to Box, TWAIN
	Speed	Up to 70 opm in colour and B/W	Destinations	2,100 (single + group) LDPA support
	Resolution	600 x 600 dpi	Functions	Annotation (text/time/date) for PDF Up to 400 job programmes
	File format	JPEG, TIFF, PDF, Compact PDF, encrypted PDF		
FAX (optional)	Compatibility	Super G3	Transmission speed	Up to 33,6 Kbps
	Protocols	Analogue, I-Fax, IP-Fax, SIP-Fax	Back-up memory	128 MB
	Resolution	Max 600 x 600 dpi (ultrafine)	Destinations	2,100 (single + group)
	Compression methods	MH, MR, MMH, JBIG	Functions	Polling, delayed transmission, PC-fax, receipt to confidential box, receipt to mail, FTP, SMB

Product performances are referred to an appropriate use under optimal conditions. With the right to change technical specifications. The registered trademarks are the property of their respective owners. d-Color MF450 and MF550 are distributed by Olivetti S.p.A. (07/07) - Code: 26193-01